

# Figure 400

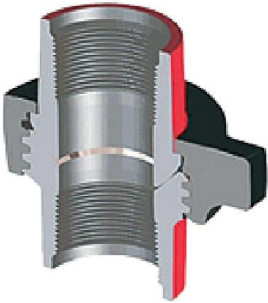

Figure 400 features a precision ball and cone sealing surface for sure metal-to-metal seal. Recommended for water, oil and gas service to 4,000 PSI NSCWP.

Standard Service		H2S Service	
NSCWP	Test	NSCWP	Test
4,000 PSI	6,000 PSI	4,000 PSI	6,000 PSI

\*All Working Pressures are Non-shock Cold Working Pressure Ratings (NSCWP)

## Figure 400 Threaded Color Code: Red Subs/Black Nut

Nominal Pipe Size	2"	3"	4"	12"
Qty. / Box	6	4	3	1
Part No.	U040200	U040300	U040400	U041200
Clearance Radius (A)	3.35"	4.125"	5.00"	10.39"
End to End Threaded (B)	5.39"	6.125"	8.125"	10.98"
Weight (lbs)	11.50	21.00	32.00	160.00
Material, Sub	A105	A105	A105	A105
Material, Nut	1045	A105	A105	A105



## Figure 400 Butt Weld Schedule 80 Color Code: Red Subs/Black Nut

Nominal Pipe Size	12"
Qty. / Box	1
Part No.	U041220
Clearance Radius (A)	10.39"
End to End (B)	10.98"
Weight (lbs)	188.00
Material, Sub	A105
Material, Nut	A105

